

# Press Mould Clamp

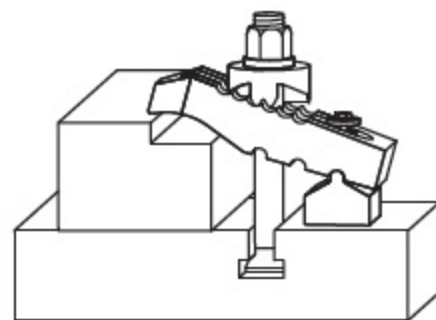
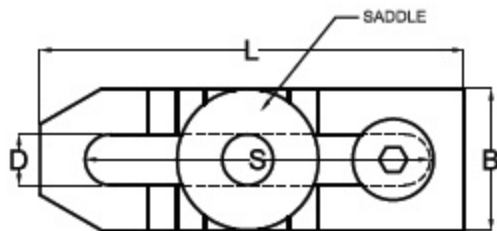

## Material:

### Clamp, Fulcrum and Saddle:

High tensile S G Iron, Enamelled in Flame Red colour.

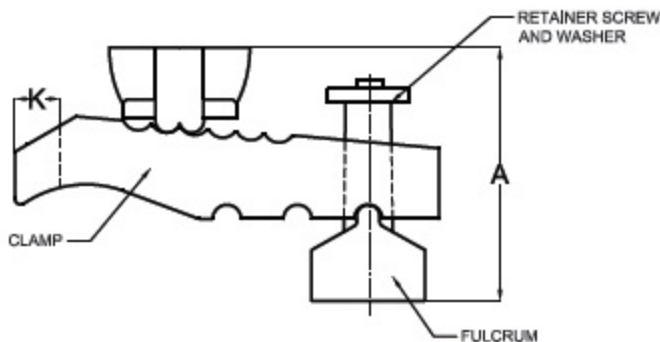

### T-Bolt, Flanged Hex Nut:

Medium Carbon Steel Hardened and tempered to 24-30 HRC and Chemically Blackened.

**Applications :** On Presses, Plastic Moulding machines, Milling and Drilling Machines.

**Note:** T1-PMC is supplied with T-Bolt as standard. Clamping Stud is optional.

TYPE: T1-PMC								
TYPE	Suitable for T-Slot in mm	D x S	L x B	A	K	Clamping Range in mm	T-Bolt Size	Weight In kg.
T1-PMC-1/12	12	18 x 125	150 x 50	80	16	0 - 65	M12 x 12 x 125L	1.65
T1-PMC-1/14	14						M12 x 14 x 125L	1.70
T1-PMC-1/16	16						M16 x 16 x 125L	1.75
T1-PMC-2/18	18	22 x 145	190 x 60	95	25	0 - 90	M16 x 18 x 200L	3.25
T1-PMC-2/20	20						M20 x 20 x 200L	3.45
T1-PMC-2/22	22						M20 x 22 x 200L	3.50
T1-PMC-3/24	24	26 x 180	240 x 65	105	33	0 - 100	M24 x 24 x 200L	4.85
T1-PMC-3/28	28						M24 x 28 x 200L	4.95