

Hex Hi-Nut

Material: Medium carbon steel, hardened and tempered to 24-32 HRC and Chemically Blackened.

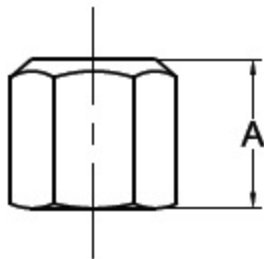
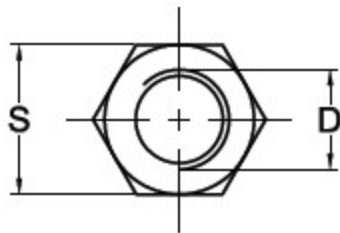

TYPE: T2-HN		DIN: 6330	
TYPE	ØD x A	S	Weight in kg
T2-HN-812	M8 x 12	13	0.010
T2-HN-1015	M10 x 15	17	0.015
T2-HN-1218	M12 x 18	19	0.025
T2-HN-1624	M16 x 24	24	0.055
T2-HN-2030	M20x 30	30	0.110
T2-HN-2436	M24 x 36	36	0.195
T2-HN-3045	M30 x 45	46	0.400
T2-HN-3654	M36 x 54	55	0.780